

# THRELKELD VILLAGE HALL



***Ideal for classes, meetings, parties, funeral teas, films, music events, theatre productions, wedding receptions and as a camping barn***

The recently revitalised Threlkeld Village Hall is an ideal venue for your event.

***Major advantages are:***

- \* a prime location with spectacular views in an attractive and popular part of the Lake District***
- \* top quality facilities***
- \* clients can make their own catering arrangements***
- \* AV facilities***
- \* Stage and stage lights***
- \* licensed for sale of alcohol***
- \* Coffee Shop open 10-5pm daily (10 – 4pm Winter) providing high quality coffee, tea, soft and alcoholic drinks, home-made cakes, and light meals.***

## **Want to Book?**

Full details of how to book and charges (standard and local rates) can be viewed online at <https://threlkeldvillagehall.org/hire-the-hall/> or email [bookings@threlkeldvillagehall.org](mailto:bookings@threlkeldvillagehall.org) for information.

## **FACILITIES AT THELKELD VILLAGE HALL**

### **Main Hall**

- Approx. 14m by 7m
- Can accommodate up to 100 seated at tables and up to 120 theatre style.
- Quality wooden floor
- Up to 120 chairs
- Up to 10 Large folding tables (1.8m by 0.75m)
- Up to 16 Small folding tables (0.9m by 0.75m)
- Up to 5 large round tables (1.5m diameter) so seat 8-10 people
- Platform staging up to 18m<sup>2</sup> by prior arrangement and erected and dismantled by us.
- AV system with microphone, DVD player, projector & screen with connections for laptops, ipods, phones.
- WiFi throughout the building
- Stage Lights
- Exercise mats
- 5 Sound screens which can be used to divide the space

**Meeting Room after 5:30pm**

This area operates as a Coffee Shop from 10 to 5pm daily (10am – 4pm in Winter) serving light meals and cakes as well as a range of drinks.

- Approx. 9m x 5.5m
- Will seat 40 people depending on layout, but ideal for meetings of up to 20.
- Portable digital projector and screen by prior arrangement
- Beautiful views to Clough Head and St John’s in the Vale
- Windows opening onto a small veranda.

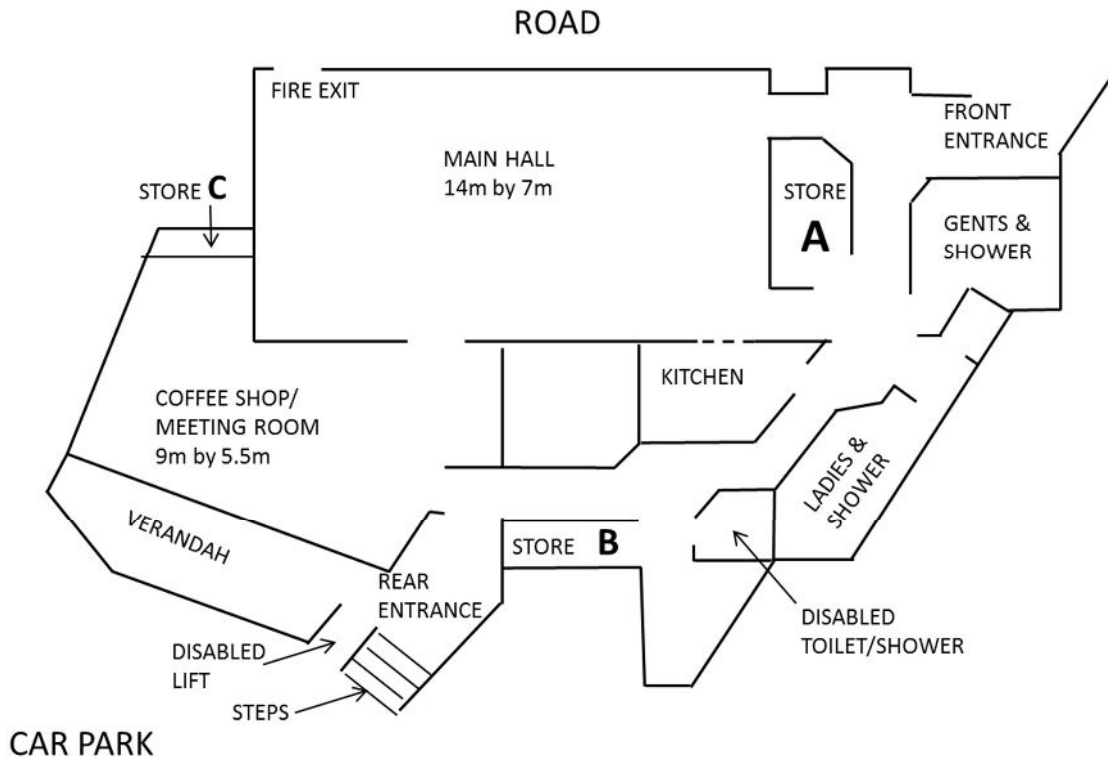

**Kitchen**

- six hob electric cooker with 2 ovens
- countertop grill and 1500W microwave
- full height fridge and separate freezer
- “hot cupboard” on castors and steel trolley
- dishwasher and washing machine
- kettles and a water boiler
- crockery and cutlery
- pans, dishes and utensils
- polycarbonate pint, half pint and wine glasses

**Toilets and Showers**

The Gents and Ladies toilets also include a shower cubicle. A disabled toilet/wet room also incorporates an accessible shower area and baby changing facilities.

**Heating**

The whole building has been insulated to very high levels, and is heated by zone controlled underfloor heating, powered by ground source heat pumps and PV cells.

**HOW TO FIND THRELKELD VILLAGE HALL**

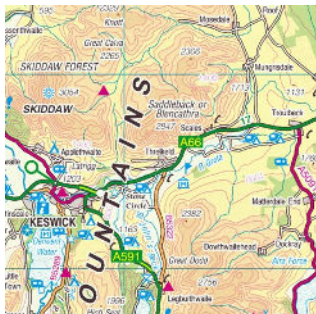

29 July 2023

**By car** - Drive into Threlkeld from the turn off the A66 at either end of the village. The Village Hall is towards the Keswick end of the village. There is a car park including space for disabled drivers, and other places to park in the vicinity.

**By bus** - The X4/X5 Keswick-Penrith service stops outside the Village Hall.

**Walking or cycling** - Threlkeld Village hall is on the C2C national cycle route.

